

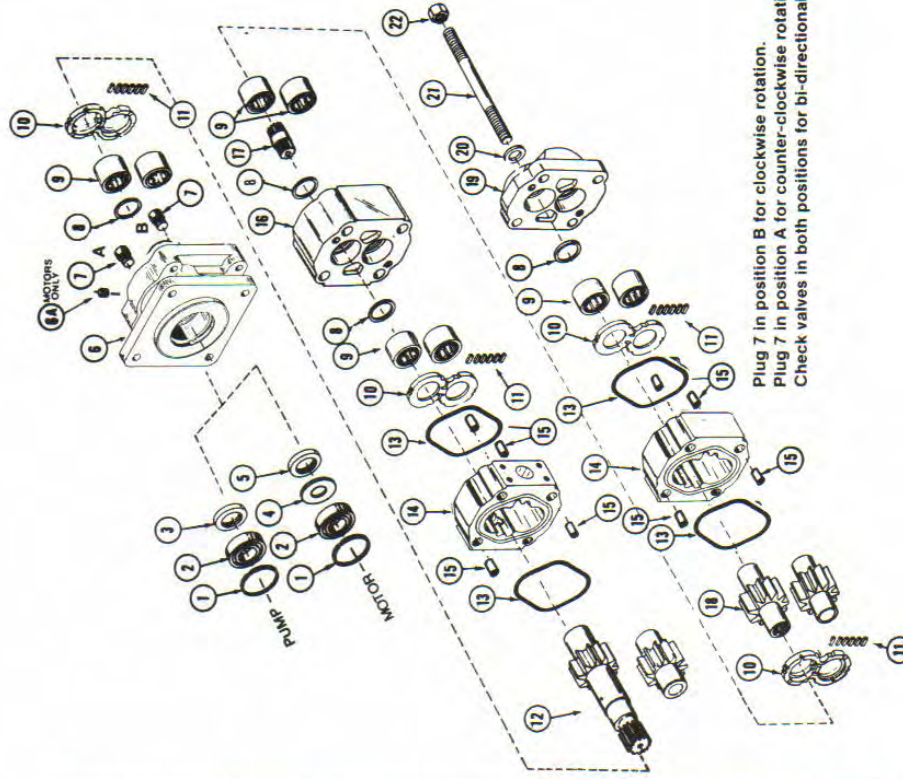

## PGP/PGM050/051 Pumps and Motors

### PGP/PGM050/051 Standard Parts List

Item No.	Description	Required	Ten Digit No. (TDN)
1	Snap Ring	1	391-2686-065
2	Outboard Bearing	1	391-0381-077
3	Outboard Spacer	1	391-3383-087
4	Lip Seal (pump)	1	391-2883-103
5	Seal Retainer (motor)	1	391-3383-020
6	Lip Seal (motor)	1	391-2883-115
6A	Shaft End Cover	1	313-50XX-XXX
7	Drain Plug (motor)	1	391-2282-XXX
7	Check Assemblies for Motors & Bi-Rotational Pumps	2	391-3681-001
8	Plugs (pumps only)	1	391-2286-004
9	Ring Seals (per gear section)	2	391-2585-009
9	Roller Bearings (per gear section)	4	391-0381-905
10	Thrust plates (motor)	2	391-2185-912
10	Thrust plates (pump)	2	391-2185-929
11	Pocket Seals (per gear section)	1 strip	391-2882-022 (Viton) 391-2882-051 (Buna)
12	Drive Shaft Gear Set	1 Set	313-29XX-XXX
13	Gasket Seals (per gear section)	2	391-2884-021
14	Gear Housing	1	313-8XXX-XXX
15	Dowel Pins (series 51)	4	391-2082-032
16	Bearing Carrier	-	313-7XXX-XXX
17	Connecting Shaft	-	313-1133-001
18	Gear Set	set	313-28XX-XXX
19	Port End Cover	1	313-3XXX-XXX
20	Washers	4	391-3784-028
21	Cap Screws (single units)	4	391-1401-XXX
21	Studs (multiple units)	4	391-1425-XXX
22	Nuts (multiple units)	4	391-1451-076



Plug 7 in position B for clockwise rotation.  
 Plug 7 in position A for counter-clockwise rotation.  
 Check valves in both positions for bi-directional unit